

KF29611

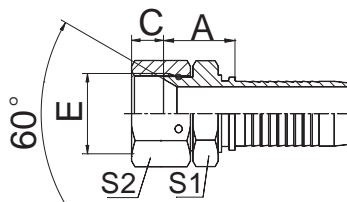

KF29611-W

日本英制内螺纹 60° 内锥面  
JIS GAS FEMALE 60° CONE SEAT  
JIS B8363

代号 PART NO.	螺纹 E THREAD E	胶管 HOSE BORE		尺寸 DIMENSIONS			
		公称内径 DN	标号 DASH	A	C	S1	S2
KF29611-02-03	G1/8"X28	5	03	20	7	14	14
KF29611-04-04	G1/4"X19	6	04	21	8	19	19
KF29611-04-05	G1/4"X19	8	05	21	8	19	19
KF29611-06-04	G3/8"X19	6	04	23	9	22	22
KF29611-06-06	G3/8"X19	10	06	23	9	22	22
KF29611-08-06	G1/2"X14	10	06	28	12	27	27
KF29611-08-08	G1/2"X14	12	08	26.5	12	27	27
KF29611-10-10	G5/8"X14	16	10	30.5	11.5	30	30
KF29611-12-10	G3/4"X14	16	10	30	13.5	32	32
KF29611-12-12	G3/4"X14	20	12	30.5	13.5	32	32
KF29611-16-16	G1"X11	25	16	32	16	41	41
KF29611-20-20W	G1.1/4"X11	32	20	43	18.5	50	50
KF29611-24-24W	G1.1/2"X11	40	24	43.5	19	55	55
KF29611-32-32W	G2"X11	50	32	46.5	23	70	70

注：1. 表中代号用于编织软管。 2. 如需用于缠绕软管代号改为 29612-xx-xx。

Note: 1.For use with braided hoses. 2.If use with spiral hoses, hose fitting series number is 29612-xx-xx.