

直通接头  
STRAIGHT FITTINGS

**KF1C**  
**KF1D**

**KF1C-RN**  
**KF1D-RN**

代号 PART NO.	螺纹 THREAD		管子外径 TUBE O.D.		尺寸 DIMENSIONS						压力等级 MPa
	E	F	D1	D2	l1	L1	S1	S2	S3		
KF1C-12	M12X1.5	M12X1.5	6	6	10	39	12	14	14	31.5 轻系列 L	
KF1C-14	M14X1.5	M14X1.5	8	8	11	40	14	17	17		
KF1C-16	M16X1.5	M16X1.5	10	10	13	42	17	19	19		
KF1C-18	M18X1.5	M18X1.5	12	12	14	43	19	22	22		
KF1C-22	M22X1.5	M22X1.5	15	15	16	46	24	27	27		
KF1C-26	M26X1.5	M26X1.5	18	18	16	48	27	32	32		
KF1C-30	M30X2	M30X2	22	22	20	52	32	36	36	16 轻系列 L	
KF1C-36	M36X2	M36X2	28	28	21	54	41	41	41		
KF1C-45	M45X2	M45X2	35	35	20	63	46	50	50		
KF1C-52	M52X2	M52X2	42	42	21	66	55	60	60		
KF1D-14	M14X1.5	M14X1.5	6	6	16	45	14	17	17	63 重系列 S	
KF1D-16	M16X1.5	M16X1.5	8	8	18	47	17	19	19		
KF1D-18	M18X1.5	M18X1.5	10	10	17	49	19	22	22		
KF1D-20	M20X1.5	M20X1.5	12	12	19	51	22	24	24		
KF1D-22	M22X1.5	M22X1.5	14	14	22	57	24	27	27		
KF1D-24	M24X1.5	M24X1.5	16	16	21	57	27	30	30	40 重系列 S	
KF1D-30	M30X2	M30X2	20	20	23	66	32	36	36		
KF1D-36	M36X2	M36X2	25	25	26	74	41	46	46		
KF1D-42	M42X2	M42X2	30	30	27	80	46	50	50		
KF1D-52	M52X2	M52X2	38	38	29	90	55	60	60	31.5重系列S	

注：如需带卡套及卡套螺母整套订货，则请在代号后加“RN”，如1C9-30RN。  
 Note: In case if you are interested to order the adapter in complete set with cutting ring and nut ,it is necessary to insert suffix "RN" after our part no., for example 1C9-30RN.

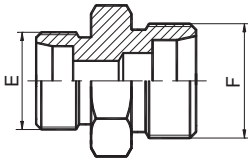

**KF1C**  
**KF1D**

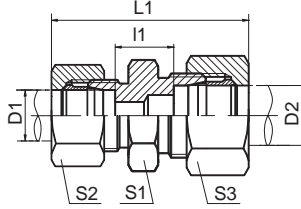

**KF1C-RN**  
**KF1D-RN**

直通变径接头  
STRAIGHT REDUCERS

代号 PART NO.	螺纹 THREAD		管子外径 TUBE O.D.		尺寸 DIMENSIONS					压力等级 MPa
	E	F	D1	D2	L1	l1	S1	S2	S3	
KF1C-12-14	M12X1.5	M14X1.5	6	8	40	11	14	15	17	31.5 轻系列 L
KF1C-12-16	M12X1.5	M16X1.5	6	10	41	12	17	15	19	
KF1C-12-18	M12X1.5	M18X1.5	6	12	42	13	19	15	22	
KF1C-14-16	M14X1.5	M16X1.5	8	10	41	13	17	17	19	
KF1C-14-18	M14X1.5	M18X1.5	8	12	42	13	19	17	22	
KF1C-16-18	M16X1.5	M18X1.5	10	12	43	14	19	19	22	
KF1C-16-22	M16X1.5	M22X1.5	10	15	44.5	15	24	19	27	
KF1C-16-26	M16X1.5	M26X1.5	10	18	46	15.5	27	19	32	
KF1C-18-22	M18X1.5	M22X1.5	12	15	44.5	15	24	22	27	
KF1C-18-26	M18X1.5	M26X1.5	12	18	46	15.5	27	22	32	
KF1C-18-30	M18X1.5	M30X2	12	22	48	17.5	32	22	36	
KF1C-22-26	M22X1.5	M26X1.5	15	18	47.5	16.5	27	27	32	
KF1C-22-30	M22X1.5	M30X2	15	22	49.5	18.5	32	27	36	
KF1C-26-30	M26X1.5	M30X2	18	22	50	18	32	32	36	
KF1C-26-36	M26X1.5	M36X2	18	28	51.5	19	41	32	41	
KF1C-30-36	M30X2	M36X2	22	28	53.5	21	41	36	41	
KF1C-30-45	M30X2	M45X2	22	35	58.5	21	46	36	50	
KF1C-36-45	M36X2	M45X2	28	35	59	21	46	41	50	
KF1D-14-16	M14X1.5	M16X1.5	6	8	47	18	17	17	19	63 重系列 S
KF1D-14-18	M14X1.5	M18X1.5	6	10	48	17.5	19	17	22	
KF1D-14-20	M14X1.5	M20X1.5	6	12	50	19.5	22	17	24	
KF1D-16-18	M16X1.5	M18X1.5	8	10	48	17.5	19	19	22	
KF1D-16-20	M16X1.5	M20X1.5	8	12	50	19.5	22	19	24	
KF1D-18-20	M18X1.5	M20X1.5	10	12	51	19	22	22	24	
KF1D-18-22	M18X1.5	M22X1.5	10	14	54	20.5	24	22	27	
KF1D-18-30	M18X1.5	M30X2	10	20	59.5	22	32	22	36	
KF1D-20-22	M20X1.5	M22X1.5	12	14	54	20.5	24	24	27	
KF1D-20-24	M20X1.5	M24X1.5	12	16	54	20	27	24	30	
KF1D-20-30	M20X1.5	M30X2	12	20	59.5	22	32	24	36	
KF1D-22-24	M22X1.5	M24X1.5	14	16	57	21.5	27	27	30	
KF1D-24-30	M24X1.5	M30X2	16	20	62.5	23	32	30	36	
KF1D-24-36	M24X1.5	M36X2	16	25	67.5	25.5	41	30	46	
KF1D-30-36	M30X2	M36X2	20	25	71	25.5	41	36	46	
KF1D-30-42	M30X2	M42X2	20	30	74	26	46	36	50	
KF1D-36-42	M36X2	M42X2	25	30	77	26.5	46	46	50	
KF1D-42-52	M42X2	M52X2	30	38	86.5	28.5	55	50	60	31.5重系列S

注：如需带卡套及卡套螺母整套订货，则请在代号后加“RN”，如1C9-30RN。  
Note: In case if you are interested to order the adapter in complete set with cutting ring and nut ,it is necessary to insert suffix "RN" after our part no. , for example 1C9-30RN.