

KF22641

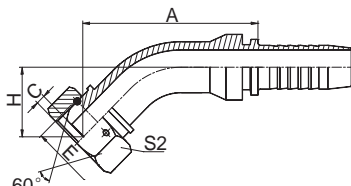

KF22641-W

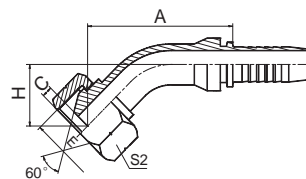

KF22641-T

45° 英管内螺纹 60° 外锥面  
45° BSP FEMALE 60° CONE

代号 PART NO.	螺纹 E THREAD E	胶管 HOSE BORE		尺寸 DIMENSIONS			
		公称内径 DN	标号 DASH	A	C	H	S2
KF22641-04-04	G1/4"X19	6	04	42.3	5.5	20.2	19
KF22641-06-04	G3/8"X19	6	04	43.2	6.3	21	22
KF22641-06-05	G3/8"X19	8	05	45.3	6.3	22	22
KF22641-06-06	G3/8"X19	10	06	46.9	6.3	22.6	22
KF22641-08-06T	G1/2"X14	10	06	48.1	7.5	23.9	27
KF22641-08-08	G1/2"X14	12	08	61.1	7.5	26.1	27
KF22641-10-08	G5/8"X14	12	08	61.4	9.5	26.5	30
KF22641-10-10	G5/8"X14	16	10	72.6	9.5	27.8	30
KF22641-12-08T	G3/4"X14	12	08	61.8	10.9	26.9	32
KF22641-12-10	G3/4"X14	16	10	73	10.9	28.2	32
KF22641-12-12	G3/4"X14	20	12	79.2	10.9	31.8	32
KF22641-16-12T	G1"X11	20	12	80.8	11.7	33.4	41
KF22641-16-16	G1"X11	25	16	88.4	11.7	34.2	41
KF22641-20-16T	G1.1/4"X11	25	16	85.3	11	31.1	50
KF22641-20-20W	G1.1/4"X11	32	20	98.8	11	38	50
KF22641-24-24W	G1.1/2"X11	40	24	116.8	13	45.5	55
KF22641-32-32W	G2"X11	50	32	135.7	16	52.7	70

注：1. 表中代号用于编织软管。 2. 如需用于缠绕软管代号改为 22642-xx-xx。

Note: 1. For use with braided hoses. 2. If use with spiral hoses, hose fitting series number is 22642-xx-xx.