

KF20491

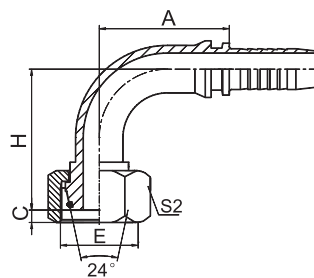

KF20491-T

90° 公制内螺纹 24° 锥带 O 形圈轻系列
90° METRIC FEMALE 24° CONE O-RING L.T.
ISO 12151-2--DIN 3865

代号 PART NO.	螺纹 E THREAD E	胶管 HOSE BORE		管子外径 TUBE O.D.	O 形圈 O RING	尺寸 DIMENSIONS			
		公称内径 DN	标号 DASH			A	C	H	S2
KF20491-12-03	M12X1.5	5	03	6	O04.5X1.5	26.5	1	35	17
KF20491-12-04	M12X1.5	6	04	6	O04.5X1.5	30	1	44.5	17
KF20491-14-04	M14X1.5	6	04	8	O06.5X1.5	30	2	38	19
KF20491-16-04	M16X1.5	6	04	10	O08.0X1.5	30	2	39	22
KF20491-16-05	M16X1.5	8	05	10	O08.0X1.5	33	2	42	22
KF20491-16-06	M16X1.5	10	06	10	O08.0X1.5	35.3	2	51.8	22
KF20491-18-05T	M18X1.5	8	05	12	O10.0X1.5	33	1.5	42.5	22
KF20491-18-06	M18X1.5	10	06	12	O10.0X1.5	35.3	2.5	44.3	24
KF20491-22-06T	M22X1.5	10	06	15	O12.0X2.0	35.3	3	44.8	27
KF20491-22-08	M22X1.5	12	08	15	O12.0X2.0	41	2.5	52	27
KF20491-26-08T	M26X1.5	12	08	18	O15.0X2.0	41	2.1	51	32
KF20491-26-10	M26X1.5	16	10	18	O15.0X2.0	56	2.5	58.5	32
KF20491-26-12	M26X1.5	20	12	18	O15.0X2.0	64.9	2.5	77	32
KF20491-27-10T	M27X1.5	16	10	18	O15.0X2.0	56	2.1	54.9	32
KF20491-27-12	M27X1.5	20	12	18	O15.0X2.0	64.9	2.5	77	32
KF20491-30-10T	M30X2	16	10	22	O20.0X2.0	56	3.8	57.2	36
KF20491-30-12	M30X2	20	12	22	O20.0X2.0	65.5	4	63	36
KF20491-36-12T	M36X2	20	12	28	O26.0X2.0	65.5	4.5	66.5	46
KF20491-36-14T	M36X2	22	14	28	O26.0X2.0	71.2	4.5	67.5	46
KF20491-45-16T	M45X2	25	16	35	O32.0X2.5	76.7	4	75	55
KF20491-45-20T	M45X2	32	20	35	O32.0X2.5	91.5	4	86	55
KF20491-52-20T	M52X2	32	20	42	O38.0X2.5	93	4	87	60
KF20491-52-24T	M52X2	40	24	42	O38.0X2.5	109.4	4	100.5	60

注：1. 表中代号用于编织软管。 2. 如需用于缠绕软管代号改为 20492-xx-xx。
Note: 1.For use with braided hoses. 2.If use with spiral hoses, hose fitting series number is 20492-xx-xx.