

KF6C9
KF6D9

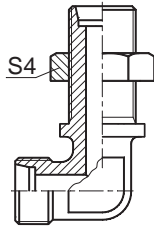

KF6C9-LN
KF6D9-LN

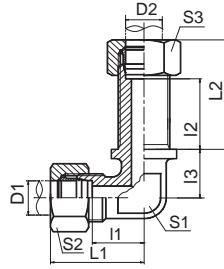

KF6C9-RN
KF6D9-RN

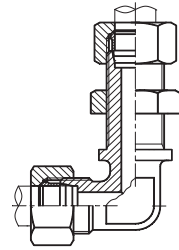

KF6C9-LN/RN
KF6D9-LN/RN

90° 弯曲过板接头
90° ELBOW BULKHEAD FITTINGS

代号 PART NO.	螺纹 THREAD		管子外径 TUBE O.D.		尺寸 DIMENSIONS								压力等级 MPa
	E	F	D1	D2	I1	I2	I3	L1	L2	S1	S2,S3	S4	
KF6C9-12	M12X1.5	M12X1.5	6	6	27	12	14	42	27	12	14	17	31.5 轻系列 L
KF6C9-14	M14X1.5	M14X1.5	8	8	27	14	17	42	29	12	17	19	
KF6C9-16	M16X1.5	M16X1.5	10	10	28	15	18	43	30	14	19	22	
KF6C9-18	M18X1.5	M18X1.5	12	12	29	17	20	44	32	17	22	24	
KF6C9-22	M22X1.5	M22X1.5	15	15	31	21	23	46	36	19	27	30	
KF6C9-26	M26X1.5	M26X1.5	18	18	32.5	23.5	24	49	40	24	32	36	
KF6C9-30	M30X2	M30X2	22	22	34.5	27.5	30	51	44	27	36	41	16 轻系列 L
KF6C9-36	M36X2	M36X2	28	28	35.5	30.5	34	52	47	36	41	46	
KF6C9-45	M45X2	M45X2	35	35	36.5	34.5	39	58	56	41	50	55	
KF6C9-52	M52X2	M52X2	42	42	36	40	43	59	63	50	60	65	
KF6D9-14	M14X1.5	M14X1.5	6	6	29	16	17	44	31	12	17	19	63 重系列 S
KF6D9-16	M16X1.5	M16X1.5	8	8	29	17	18	44	32	14	19	22	
KF6D9-18	M18X1.5	M18X1.5	10	10	29.5	17.5	20	46	34	17	22	24	
KF6D9-20	M20X1.5	M20X1.5	12	12	30.5	21.5	21	47	38	17	24	27	
KF6D9-22	M22X1.5	M22X1.5	14	14	32	22	23	50	40	19	27	30	40 重系列 S
KF6D9-24	M24X1.5	M24X1.5	16	16	31.5	24.5	24	50	43	24	30	32	
KF6D9-30	M30X2	M30X2	20	20	33.5	26.5	30	55	48	27	36	41	
KF6D9-36	M36X2	M36X2	25	25	35	30	34	59	54	36	46	46	
KF6D9-42	M42X2	M42X2	30	30	37.5	35.5	39	64	62	41	50	50	31.5重系列S
KF6D9-52	M52X2	M52X2	38	38	37	41	43	68	72	50	60	65	

注：如需带锁母订货，请在代号后加“LN”，如6C9-30LN；如需带卡套及卡套螺母订货，在代号后加“RN”，如6C9-30RN；如需带锁母、卡套及卡套螺母订货，在代号后加“LN/RN”，如6C9-30LN/RN。

Note: In case if you are interested to order the adapter with lock nut, please insert suffix "LN" after our part no. for example 6C9-30LN, order the adapter with cutting ring and nut, insert suffix "RN" after part no., for example 6C9-30RN, order the adapter with lock nut and cutting ring and nut, insert suffix "LN/RN" after part no., for example 6C9-30LN/RN.