

**KFAC  
KFAD**

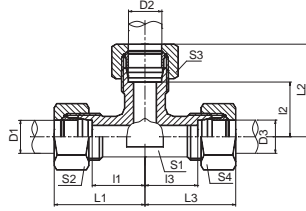

**KFAC-RN  
KFAD-RN**

三通接头  
EQUAL TEES

代号 PART NO.	螺纹 THREAD E, F, G	管子外径 TUBE O.D. D1, D2, D3	尺寸 DIMENSIONS					压力等级 MPa
			I1, I2, I3	L1, L2, L3	S1	S2, S3, S4		
KF AC-08	M8X1	4	11	21	9	10	10 特轻系列 LL	
KF AC-10	M10X1	5	9.5	21	9	12		
KF AC-10LL	M10X1	6	9.5	21	9	12		
KF AC-12LL	M12X1	8	11.5	23	12	14	25 轻系列 L	
KF AC-12	M12X1.5	6	12	27	12	14		
KF AC-14	M14X1.5	8	14	29	12	17		
KF AC-16	M16X1.5	10	15	30	14	19		
KF AC-18	M18X1.5	12	17	32	17	22		
KF AC-22	M22X1.5	15	21	36	19	27		
KF AC-26	M26X1.5	18	23.5	40	24	32	16 轻系列 L	
KF AC-30	M30X2	22	27.5	44	27	36		
KF AC-36	M36X2	28	30.5	47	36	41		
KF AC-45	M45X2	35	34.5	56	41	50		
KF AC-52	M52X2	42	40	63	50	60	63 重系列 S	
KF AD-14	M14X1.5	6	16	31	12	17		
KF AD-16	M16X1.5	8	17	32	14	19		
KF AD-18	M18X1.5	10	17.5	34	17	22		
KF AD-20	M20X1.5	12	21.5	38	17	24		
KF AD-22	M22X1.5	14	22	40	19	27	40 重系列 S	
KF AD-24	M24X1.5	16	24.5	43	24	30		
KF AD-30	M30X2	20	26.5	48	27	36		
KF AD-36	M36X2	25	30	54	36	46		
KF AD-42	M42X2	30	35.5	62	41	50		
KF AD-52	M52X2	38	41	72	50	60	31.5重系列S	

注：如需带卡套及卡套螺母整套订货，则请在代号后加“RN”，如AC-22RN。  
 Note: In case if you are interested to order the adapter in complete set with cutting ring and nut, it is necessary to insert suffix "RN" after our part no., for example AC-22RN.